

# Your Guide to Lafarge GTEC Drylining Systems

## GTEC Plasterboard Solutions

The GTEC range from Lafarge Plasterboard offers an outstanding range of products and systems for all your drylining solutions.

### GTEC Aqua Board

NEW! The ideal tile backing board for wet and high humidity areas such as bathrooms, wetrooms, saunas and swimming pools, GTEC Aqua Board offers water resistance and protection from mould and fungus. Weather durable, the gypsum based board can be left outdoors exposed for up to 6 months and is the leading alternative to cement boards.



**GTEC Aquamix**  
For use with the GTEC Aqua system in severe wet applications, GTEC Aquamix is a water resistant ready-mixed joint cement.



**GTEC AquaStrip**  
A mesh strip used in the GTEC Aqua system to protect exposed drylining perimeters for wet applications.

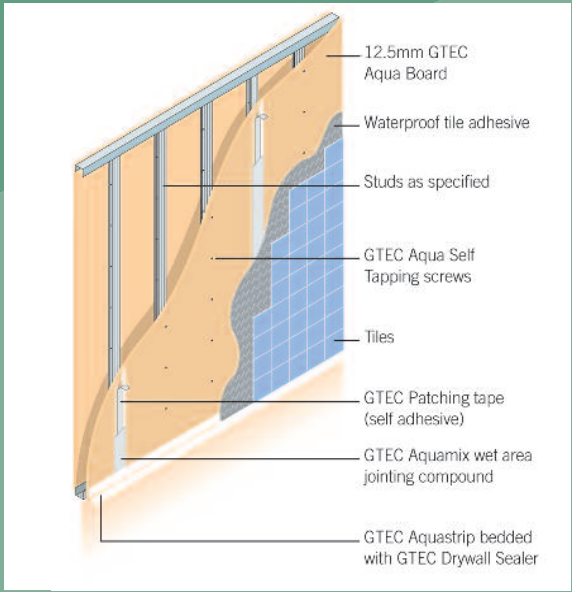



# High Performance Boards

**The GTEC board range offers high performance boards as well as standard boards to meet Building Regulations Part E (Acoustic), Part B (Fire) and Part L (Thermal).**

## GTEC dB Board

Meeting Part E Building Regulations (Acoustic), GTEC dB Board is suitable for use in stud partitions, lining systems and ceilings.

## GTEC Moisture Board

Suitable for stud partitions, lining systems and ceilings requiring moisture resistance.

## GTEC Fire Board

Providing superior fire resistance with up to 60 minutes fire rating (dependent on system used) GTEC Fire Board Meets Part B Building Regulations (Fire) and is suitable for stud partitions, lining systems and ceilings.

## GTEC Megadeco

Providing superior acoustic, fire and impact performance, Megadeco meets Part E (Acoustic) & Part B (Fire) Building Regulations. Suitable for use in stud partitions, lining systems and ceilings, Megadeco has one decorative pre-sealed white face.

## GTEC E Board

Specially designed for use within dwellings and to meet Part E Building Regulations (Acoustic), GTEC E Board is suitable for stud partitions, lining systems and ceilings.

## GTEC Acoustic Homespan

Suitable for the construction of the Lafarge GTEC Acoustic Homespan Partition System and meeting Part E Building Regulations (Acoustic).

GTEC dB Board

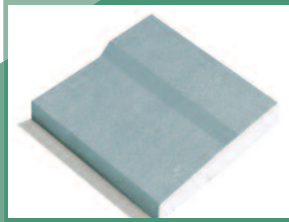

GTEC Moisture Board

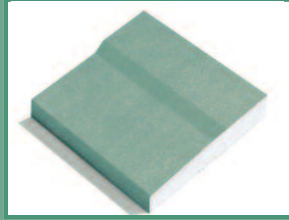

GTEC Fire Board



GTEC Megadeco

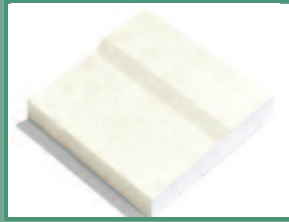

GTEC E Board

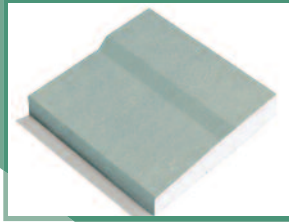

GTEC Acoustic Homespan

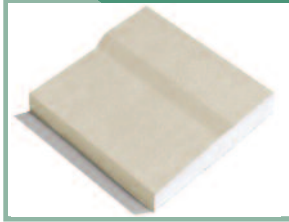

GTEC Universal



GTEC Vapour Board

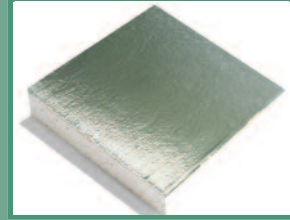

GTEC Thermal Board



GTEC Thermal XP Board



GTEC Thermal K Board

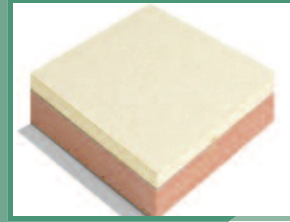

GTEC Pregybel

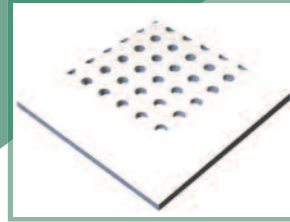

## GTEC Universal

Providing acoustic, fire and impact performance, GTEC Universal Board meets Part E (Acoustic) & Part B (Fire) Building Regulations and is suitable for use in stud partitions, lining systems and ceilings.

## GTEC Vapour Board

Suitable for installation with stud partitions, lining systems and ceilings to reduce condensation risk. GTEC Vapour Board features a silver metallised polyester film back liner.

## GTEC Thermal Board

Comprising 9.5mm standard plasterboard bonded to expanded polystyrene, GTEC Thermal Board meets Part L Building Regulations (Thermal) and is suitable for drylining to external masonry walls or to upgrade existing constructions, loft spaces, ceilings or renovations.

## GTEC Thermal XP Board

9.5mm standard plasterboard bonded to extruded polystyrene, GTEC Thermal XP Board gives thermal resistance of up to 1.57m<sup>2</sup> K/W (using GTEC Thermal XP Board 55mm). Meeting Part L Building Regulations (Thermal), GTEC Thermal XP Board is suitable for drylining to external masonry walls or to upgrade existing constructions, loft spaces, ceilings or renovations.

## GTEC Thermal K Board

9.5mm standard plasterboard bonded to phenolic foam with a vapour barrier, GTEC Thermal K Board provides superior thermal resistance of up to 3.05m<sup>2</sup> K/W (using GTEC Thermal K 70mm) and meets Part L Building Regulations (Thermal). Suitable for drylining to external masonry walls or to upgrade existing constructions, loft spaces, ceilings or renovations.

## GTEC Pregybel

A range of perforated plasterboards which combine superior sound absorption performance with an aesthetic design. GTEC Pregybel is used in ceiling applications for retail centres, offices, apartments, hospitals and commercial applications.

# GTEC Metal Stud

The GTEC Metal Stud system is an economical system for non-loadbearing lightweight fire and sound resisting partitions of heights up to 12.0m.



### GTEC C Stud

Galvanised C shaped metal section used with GTEC U Track to provide framework for wall linings and partitions.

### GTEC U Track

Galvanised U shaped metal section used with GTEC C studs to provide framework for wall linings and partitions.

### GTEC I Stud

Galvanised I shaped metal section used with GTEC U track to provide a metal frame for the main run of wall linings.

### GTEC Dryliner Track

Galvanised metal J shaped section used as a track or perimeter channel in the Lafarge GTEC Dryliner System.

### GTEC Dryliner Channel

A galvanised steel furring channel for plasterboard fixing used in the Lafarge GTEC Dryliner System.

### GTEC Primary Channel

Galvanised steel channel used to support the GTEC Ceiling Channel MFCC50 in the GTEC Suspended MF Ceiling System.

### GTEC Ceiling Channel

This galvanised steel channel forms the Lafarge GTEC Suspended MF Ceiling System.

### GTEC Resilient Bar Deep

Acoustic isolation bar for improving sound performance and minimising the risk of joints cracking due to timber movement during the drying out of timber.

### GTEC Finish

Lafarge GTEC taping and jointing systems are used for the seamless jointing of plasterboard. All our joint compounds finish white, are exceptionally smooth, and easy to sand for a very fine finish.



Compounds

**For further information contact Angela, Mike or Steve at Elliotts Insulation and Drylining on 023 8062 3960.**  
**Elliotts Insulation and Drylining**  
**8 Goodwood Road**  
**Boyatt Wood**  
**Eastleigh SO50 4NT**

Keep yourself protected with our comprehensive GTEC Lifetime System Warranty.

By using proprietary products and components supplied by Lafarge Plasterboard, you won't run the risk of compromising product or system performance.

Always insist on genuine Lafarge products!

Please ask in store for more information on Lafarge GTEC products.

For technical enquiries relating to Lafarge GTEC products and systems please call the Lafarge Technical Enquiryline on 01275 377789.